

## **Echo LED.**

And the best comes  
from above.

Efficient,  
pleasant light.

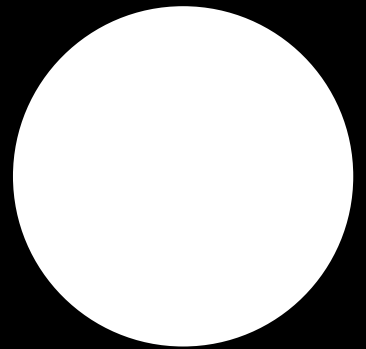



#### **It all starts with our knowledge.**

What you should know, too.

4

#### **Select your light.**

1 luminaire: 3 settings, 17 colour tones, PAL+

10

#### **Echo LED.**

Simply versatile.

14

#### **Echo LED.**

One luminaire, many options.

16

#### **Product line.**

18

**We develop for today. And tomorrow.**  
Regent product development.

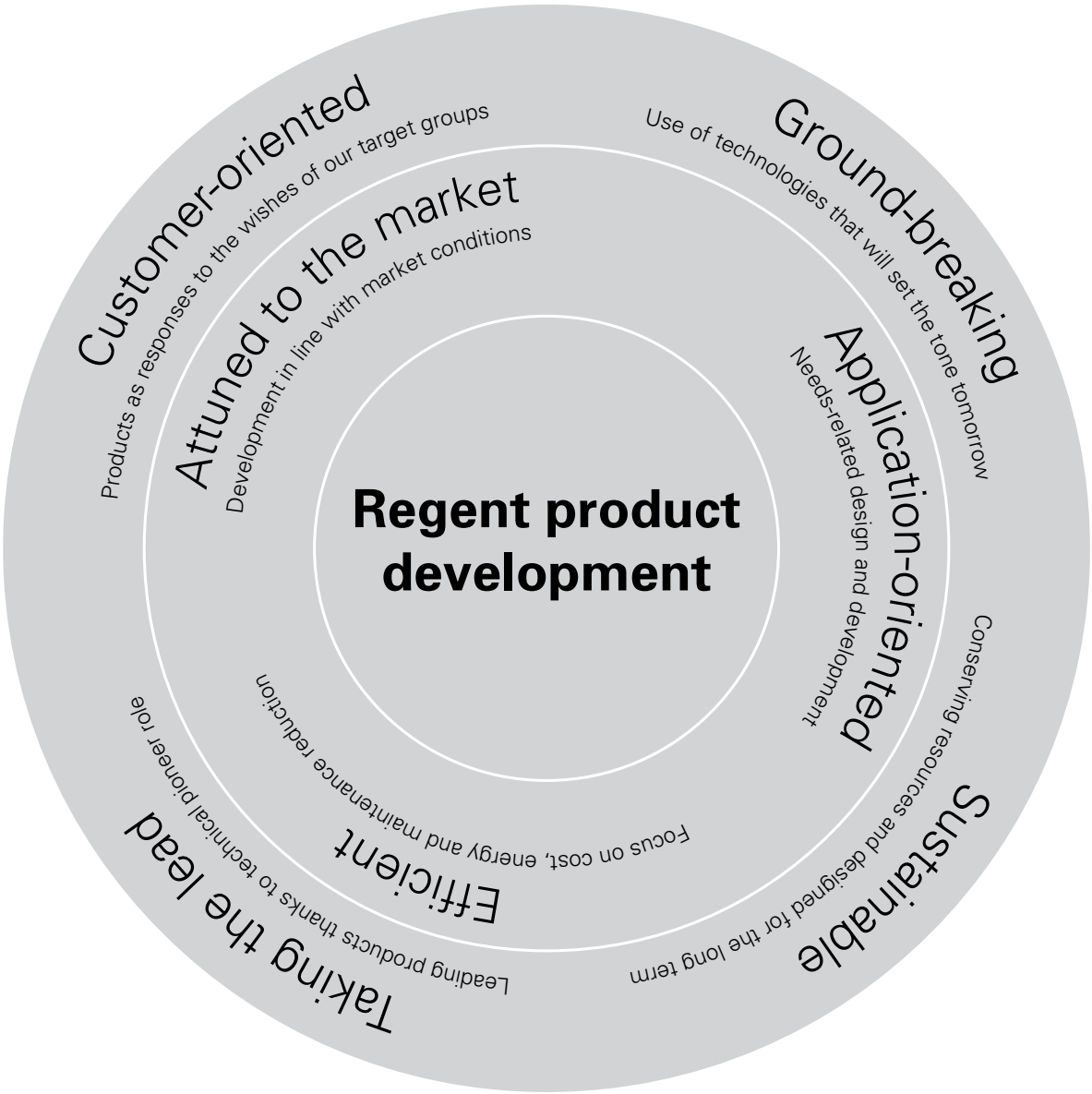

**It all starts with our knowledge.**  
What you should know, too.

When developing a lighting solution, everything must interact perfectly. Even the smallest deviation can result in far-reaching consequences. It is therefore essential that the individual specialists in product development work together in an open and transparent manner. The new LED technology with all its options presents us with a fascinating set of challenges. New innovations and materials are entering the market almost daily which need to be discovered, analysed and evaluated for possible application before they can be adopted in our products and lighting solutions. In close cooperation with universities, academies and development partners we continually educate our specialists and thereby achieve the most up-to-date level of knowledge and technology for our product development. In order to ensure a seamless and efficient process, the product development processes are continually redefined and adjusted. Nonetheless, the personal

commitment of every individual is always the main focus. This is the basis on which the overall potential of the technology can be reliably infused into our products. As a result, Regent is able to offer products, services and solutions to the market which support the innovative strength of its partners and customers and create the optimum light solutions.

The high-efficiency light mixing chamber Echo LED, the PAL+ technology, the intuitive Slider® operating element and the ALONEatWORK® communication technology are the result of these development activities which are oriented to the requirements of the modern world. They supply the answers to the challenges of the world for today as well as tomorrow.



McFit, Berlin: Echo LED 210

## The challenge.

Efficiency without sacrifice.

The office of today is characterised by the goal of maximum efficiency. As ceiling panels become ever lighter, they lose stability. Glare suppression and maximum luminance with the greatest possible efficiency are essential quality features. Assembly costs need to be kept low. Different room dimensions require different diameters. With its excellent glare suppression properties and assembly, the Downlight Echo LED is perfectly suited for office illumination.



## The solution.

The optimal downlight for optimal comfort.

Echo LED is a real highlight among downlights. Even in office use. With a filigree mounting ring, it fits unobtrusively into any architectural concept. The most modern LED technology generates a concentrated light package. The specially designed light mixing chamber with opal finish guarantees high-quality light, even with a direct view. The bayonet fitting allows for quick, tool-free assembly. The translucent reflector guard is also unique. It protects the reflector from dirt from the construction phase on to final cleaning.



Glare-free light



Reflector guard



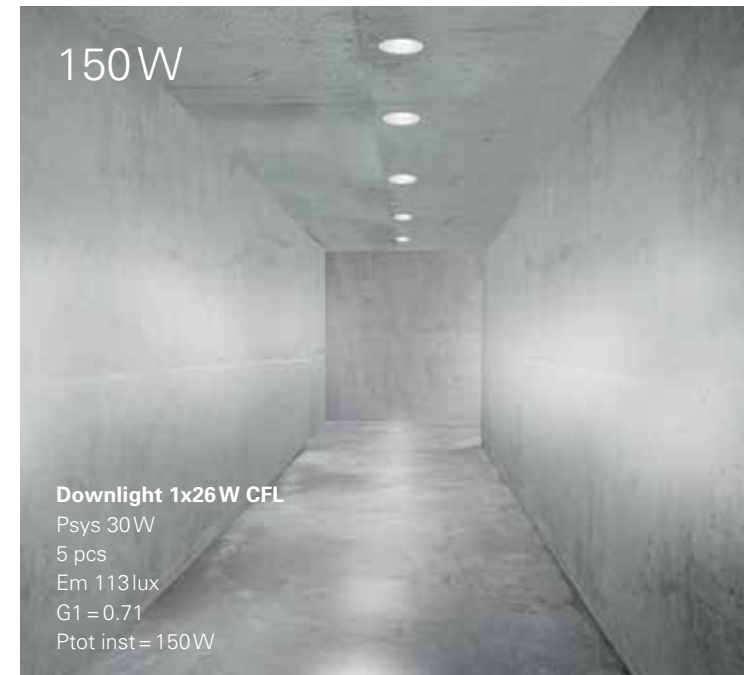
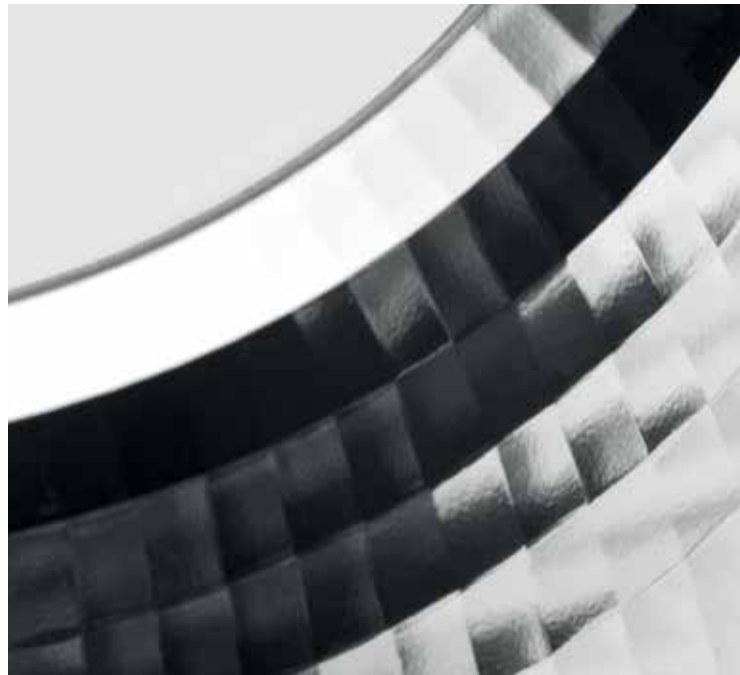

**Design:**

Technology, shape, materials,  
function

**Ergonomics:**

Visual comfort

**Environment:**

Sustainability, CO<sub>2</sub> balance, UGR < 19  
lifespan, illuminant

**Energy:**

lm/W  
thermal management

**Service:**

Lifespan  
Maintenance

**Installation:**

Handling, tool-free  
reflector guard

The Echo LED is distinguished by an integrated concept. First, the perfect interplay of all elements guarantees the highest degree of efficiency.

## Downlights with LED. For greater efficiency.

LED makes especially good sense for downlights. It beats conventional luminants in many regards and noticeably increases efficiency. The long lifespan reduces maintenance efforts, and the passive cooling saves energy and wear and tear. LED guarantees a higher light quality and precise light distribution.

**ROI < 3 years!**

**(Return on Investment):**

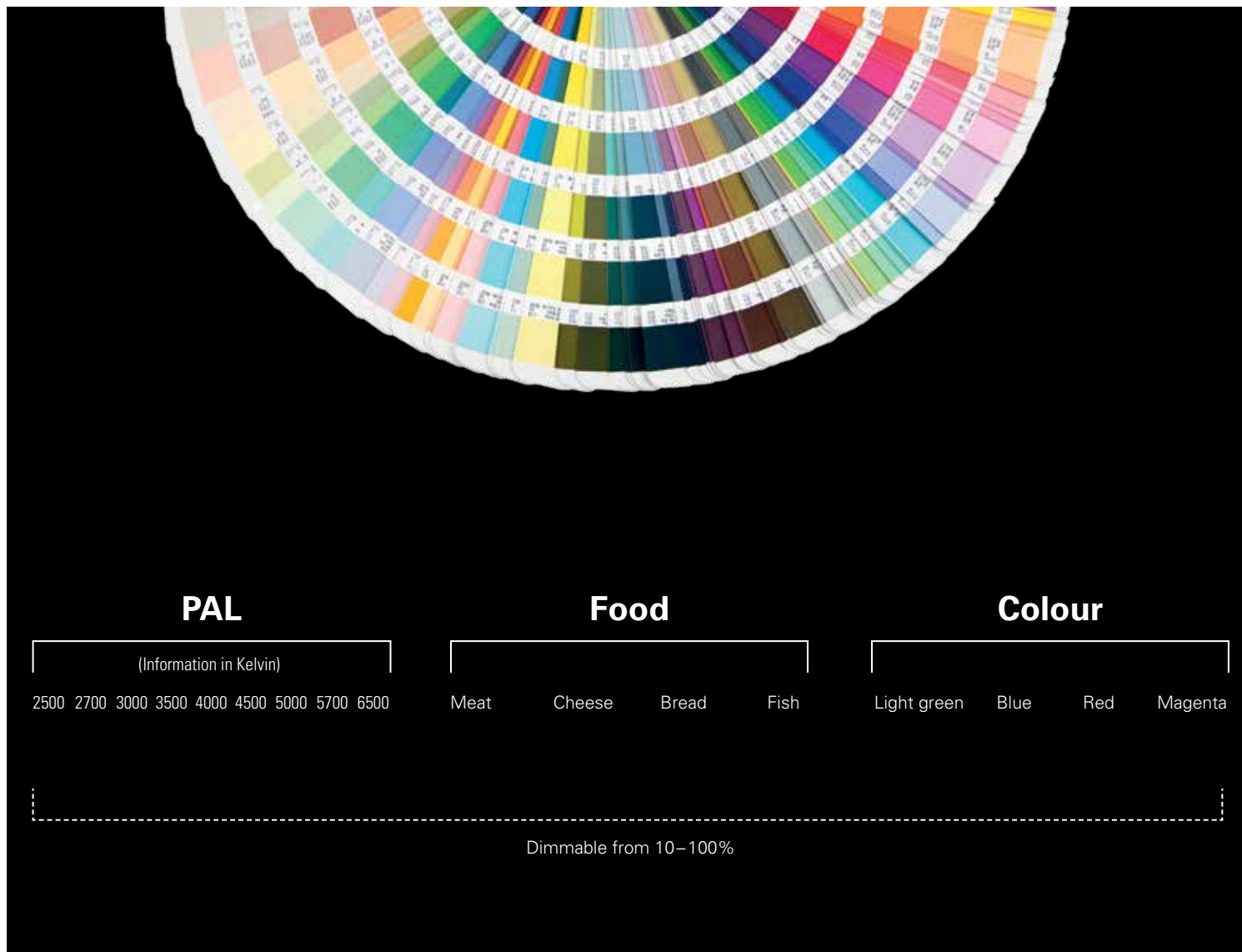

## Select your light.

1 luminaire: 3 settings, 17 colour tones, PAL+

Use the full potential of LED with the Echo LED and PAL+ technology. PAL+ (Perception Adaptive LED light source), with a colour spectrum similar to that of daylight, guarantees complete colour recognition. The genuine white LEDs combine optimal lighting for the highest demands with UV-free and warmth-free light emission. As a result, the Echo LED is ideal when colours, temperatures and light-fastness play a key role. These could be demanding applications like museums, lighting fresh food or colour-intensive non-food products.

- true-to-nature colour reproduction
- «true» white LED light
- CRI up to 94 (irrespective of dimming value) from 2500 K - 6500 K
- colour rendering and colour temperature in dimming range constant from 10–100%

## Echo LED and PAL+

More options with DMX control.

Whether to illuminate, create a mood or for decoration, variable and dynamic light is the trend. A requirement that Regent ably meets. In whatever design, Echo LED with PAL+ technology is ready for DMX. The control technology is distinguished by extreme speed, high reliability, easy integration capability and first-class operating efficiency. The customers program the light themselves so that the light can be controlled according to their individual wishes.





## Echo LED 137 / 210 / 260. Product range.

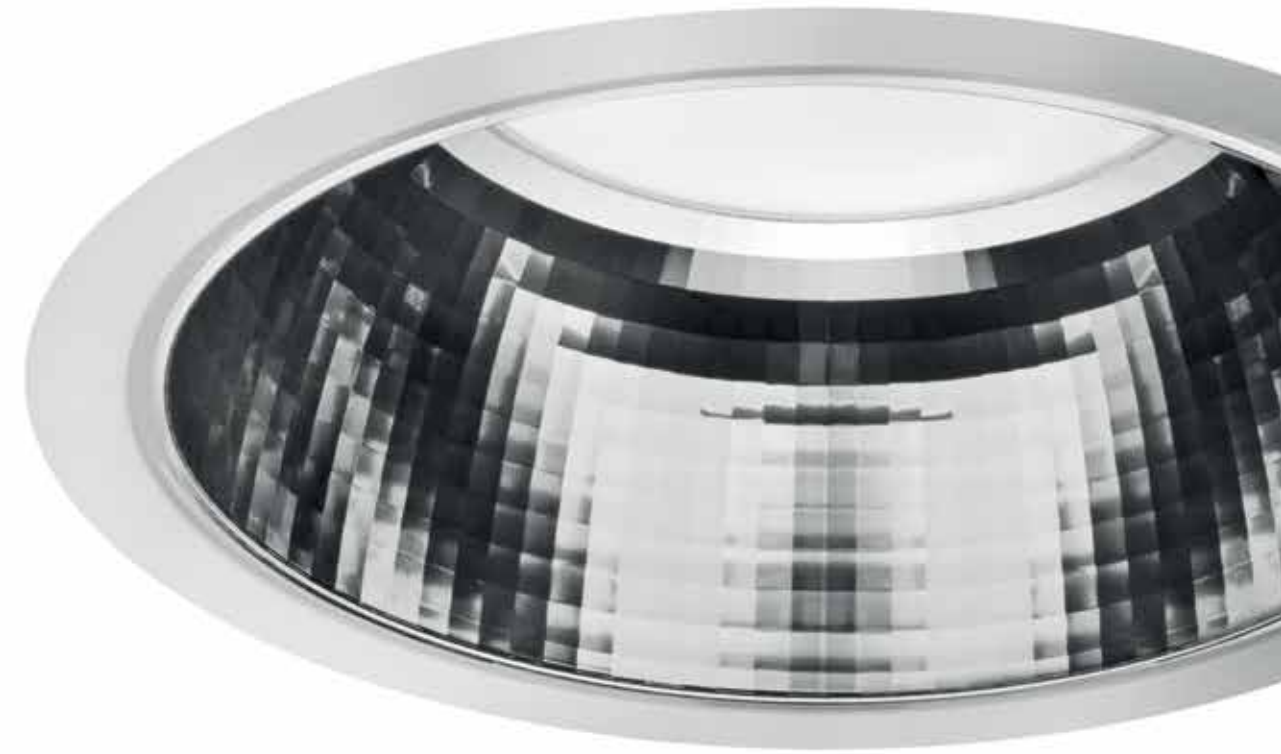

The Echo LED product line consists of three sizes 137/210/260 mm, each with three different optics (aluminised UGR < 19, aluminised wide angle, white). The fields of application are expanding with the use of PAL+, the intelligent DMX controller that can be operated via smartphone, iPad, or via a simple DMX switch, as well as in a borderless Trimless version.

The wide selection of accessories can be installed without use of tools which expands the possible applications of the Echo LED Downlight. The reflector guard protects the reflector from dirt and damage during the construction phase, and provides light to the construction site during the construction phase.



- Recessed downlight Echo LED 137 / 210 / 260, LED (Light Emitting Diode) with pleasantly harmonised luminance
- High efficiency up to 88lm/W
- Passive cooling, integrated electronic control gear, ON/OFF/regulated DALI
- Heat sink made of extruded aluminium section



- ceiling mounted without tools
- with assembly aid for hands-free connecting
- accessory mounting with no tools
- Glare-free light UGR < 19, thanks to high-precision lighting design
- transparent reflector guard for construction phase
- Protection class I, IP20 / IP44 from below for closed ceiling (up to IP55 with accessories!)
- LED 3000K or 4000K, CRI > 83
- PAL+ 2500K-6500K, CRI up to 94

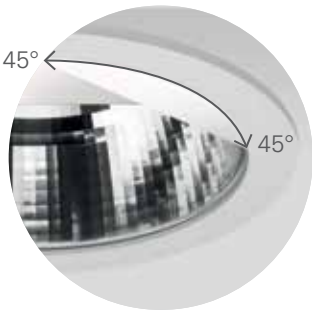

Wallwasher reflector rotates 45° to both sides



Mounting ring made of steel with fitting spring for ceiling installation without tools for ceiling thicknesses of 1–30 mm Bayonet connection for reflector

## Echo LED. Simply versatile.

Performance, lightweight design, ease of installation and office sustainability are one thing. What makes the new Downlight Echo LED so unique is not just the technical values, but also the large number of fields of application. With three different sizes, the Downlight Echo LED can meet almost any desired installation need. Without losing efficiency and effectiveness. At the same time, rooms are reliably illuminated from a ceiling height of up to 10 meters.



Discover light  
in motion.  
[www.vimeo.com/62063581](https://www.vimeo.com/62063581)



## Echo LED.

One luminaire, many options.

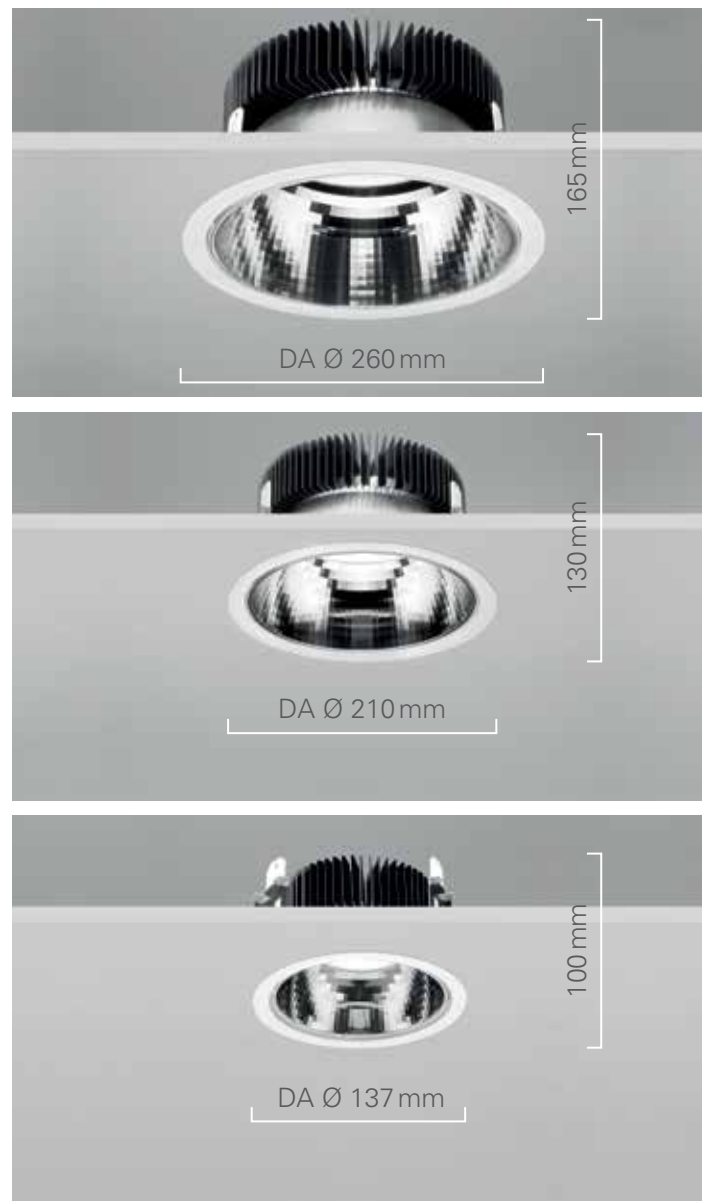

### Good things come in threes.

In order to be able to flexibly illuminate any room size with optimal light, the Echo LED was planned, implemented and equipped with various accessories in three sizes. As a result, there are hardly any limits on the side of the downlight for planning or renovating.

DA Ø 137/210/260 mm = ceiling section



### Seamless transfer with Trimless.

Optimise the appearance of the building or room and let the Echo LED move into the background with the Trimless version. Thanks to intelligent construction, the borderless luminaire forms a unit with the ceiling structure.

## Echo LED.

Installation – nothing easier than that.



### Find success without tools.

It doesn't get any easier – in three steps without tools and with one hand, the Echo LED can be inserted in any prepared opening. The light weight is the result of its design. The bayonet fitting and the sophisticated quick mounting technology mean uncomplicated installation. Your efficiency is increased even before you switch it on the first time.

- efficiency in lightweight construction
- concentrated and glare-free LED light package
- easy, fast installation
- transparent reflector guard for construction phase

### Use before construction is completed.

Save money by using the Downlight Echo LED as temporary building site illumination. Use the Echo LED to illuminate the rooms not yet completed. At the same time, the transparent guard protects the reflector from dust and other possible damage. Once construction is completed, the reflector guard can simply be removed and disposed of.

Echo LED 137.



IP20  
IP44\*

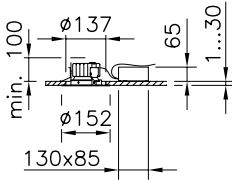

LED

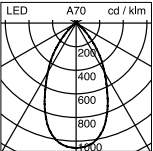

Medium,  
high gloss  
UGR <19

Psys 16W  
TCP 3000 K  
LL 1350 lm  
TCP 4000 K  
LL 1400 lm  
CRI >83  
L70/50'000 h  
**PAL+**  
2500-6500 K  
LL 1200 lm  
CRI up to 94

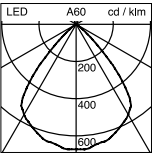

Flood, high gloss

Psys 16W  
TCP 3000 K  
LL 1350 lm  
TCP 4000 K  
LL 1400 lm  
CRI >83  
L70/50'000 h  
**PAL+**  
2500-6500 K  
LL 1200 lm  
CRI up to 94

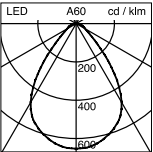

Flood, white

Psys 16W  
TCP 3000 K  
LL 1050 lm  
TCP 4000 K  
LL 1100 lm  
CRI >83  
L70/50'000 h  
**PAL+**  
2500-6500 K  
LL 950 lm  
CRI up to 94

1400lm replaces HIT 20W,  
CFL 1x26W or 2x18W

	Beam angle	Reflector surface	Kelvin	Control gear	Ref. N°	Ref. N° Trimless*
Note		facetted				4th quarter 2013
16W	Medium	high gloss	3000 K	ON/OFF	24.1M18DA.00	24T.1M18DA.00
16W	Medium	high gloss	3000 K	regulated DALI	24.1M18DC.00	24T.1M18DC.00
16W	Medium	high gloss	4000 K	ON/OFF	24.1M18JA.00	24T.1M18JA.00
16W	Medium	high gloss	4000 K	regulated DALI	24.1M18JC.00	24T.1M18JC.00
19W	Medium	high gloss	PAL+	DMX	24.1M157E.00 4th quarter 2013	24T.1M157E.00
16W	Flood	high gloss	3000 K	ON/OFF	24.1F18DA.00	24T.1F18DA.00
16W	Flood	high gloss	3000 K	regulated DALI	24.1F18DC.00	24T.1F18DC.00
16W	Flood	high gloss	4000 K	ON/OFF	24.1F18JA.00	24T.1F18JA.00
16W	Flood	high gloss	4000 K	regulated DALI	24.1F18JC.00	24T.1F18JC.00
19W	Flood	high gloss	PAL+	DMX	24.1F157E.00 4th quarter 2013	24T.1F157E.00
16W	Flood	white	3000 K	ON/OFF	24W1F18DA.00	24TW1F18DA.00
16W	Flood	white	3000 K	regulated DALI	24W1F18DC.00	24TW1F18DC.00
16W	Flood	white	4000 K	ON/OFF	24W1F18JA.00	24TW1F18JA.00
16W	Flood	white	4000 K	regulated DALI	24W1F18JC.00	24TW1F18JC.00
19W	Flood	white	PAL+	DMX	24W1F157E.00 4th quarter 2013	24TW1F157E.00

For emergency version

Ordering example: 24.1M18DA.00 → **N**24.1M18DA**U**00 1 hour battery 3W  
24.1M18DA.00 → **N**24.1M18DA**W**00 3 hour battery 1W

other optional luminaire light fluxes upon request: 1250lm (14 W)/1750lm (21 W)

Accessories for LED 137.

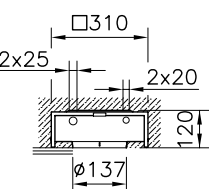

Decorative cover ring	Decorative cover ring with clear glass	Decorative cover ring with matt glass	Decorative cover ring with wallwasher	ring for ceiling reinforcement	concrete recessed box
Ø 157 mm, (outside)	IP55 from below Ø 157 mm, (outside)	IP55 from below Ø 157 mm, (outside)	90° adjust. after instal. Ø 157 mm, (outside)	ring thickness = 8 mm ceiling thickness < 3 mm	
24RIW137.01 white 24RIH137.01 silver	24RIW137K.01 white 24RIH137K.01 silver		24SETM137.01W white 24SETM137.01H silver	24SET137.01	24EB137.01
24RIW137.01 white 24RIH137.01 silver	24RIW137K.01 white 24RIH137K.01 silver		24SETM137.01W white 24SETM137.01H silver	24SET137.01	24EB137.01
24RIW137.01 white 24RIH137.01 silver	24RIW137K.01 white 24RIH137K.01 silver		24SETM137.01W white 24SETM137.01H silver	24SET137.01	24EB137.01
24RIW137.01 white 24RIH137.01 silver	24RIW137K.01 white 24RIH137K.01 silver		24SETM137.01W white 24SETM137.01H silver	24SET137.01	24EB137.01
24RIW137.01 white 24RIH137.01 silver	24RIW137K.01 white 24RIH137K.01 silver		24SETM137.01W white 24SETM137.01H silver	24SET137.01	upon request
24RIW137.01 white 24RIH137.01 silver	24RIW137K.01 white 24RIH137K.01 silver		24SETF137.01W white 24SETF137.01H silver	24SET137.01	24EB137.01
24RIW137.01 white 24RIH137.01 silver	24RIW137K.01 white 24RIH137K.01 silver		24SETF137.01W white 24SETF137.01H silver	24SET137.01	24EB137.01
24RIW137.01 white 24RIH137.01 silver	24RIW137K.01 white 24RIH137K.01 silver		24SETF137.01W white 24SETF137.01H silver	24SET137.01	24EB137.01
24RIW137.01 white 24RIH137.01 silver	24RIW137K.01 white 24RIH137K.01 silver		24SETF137.01W white 24SETF137.01H silver	24SET137.01	24EB137.01
24RIW137.01 white 24RIH137.01 silver	24RIW137K.01 white 24RIH137K.01 silver		24SETF137.01W white 24SETF137.01H silver	24SET137.01	upon request
24RIW137.01 white 24RIH137.01 silver	24RIW137K.01 white 24RIH137K.01 silver	24RIW137D.01 white 24RIH137D.01 silver		24SET137.01	24EB137.01
24RIW137.01 white 24RIH137.01 silver	24RIW137K.01 white 24RIH137K.01 silver	24RIW137D.01 white 24RIH137D.01 silver		24SET137.01	24EB137.01
24RIW137.01 white 24RIH137.01 silver	24RIW137K.01 white 24RIH137K.01 silver	24RIW137D.01 white 24RIH137D.01 silver		24SET137.01	24EB137.01
24RIW137.01 white 24RIH137.01 silver	24RIW137K.01 white 24RIH137K.01 silver	24RIW137D.01 white 24RIH137D.01 silver		24SET137.01	24EB137.01
24RIW137.01 white 24RIH137.01 silver	24RIW137K.01 white 24RIH137K.01 silver	24RIW137D.01 white 24RIH137D.01 silver		24SET137.01	upon request

\*Rimless for plastering; for product photo see page 16, not compatible with accessories

\*IP44 from below for closed ceilings



Echo LED 210.

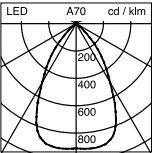

Medium,  
high gloss  
UGR <19

Medium  
Psys 36W  
TCP 3000 K  
LL 2650 lm  
TCP 4000 K  
LL 2700 lm  
CRI > 83  
L70 50'000 h  
**PAL+**  
2500-6500 K  
LL 2300 lm  
CRI up to 94

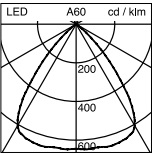

Flood, high gloss

Flood  
Psys 36W  
TCP 3000 K  
LL 2700 lm  
TCP 4000 K  
LL 2750 lm  
CRI > 83  
L70 50'000 h  
**PAL+**  
2500-6500 K  
LL 2200 lm  
CRI up to 94

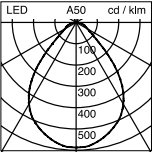

Flood, white

White Reflektor  
Psys 36W  
TCP 3000 K  
LL 2600 lm  
TCP 4000 K  
LL 2650 lm  
CRI > 83  
L70 50'000 h  
**PAL+**  
2500-6500 K  
LL 2100 lm  
CRI up to 94

2700lm replaces HIT 35W,  
or CFL 2x26W

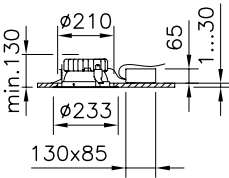

	Beam angle	Reflector surface	Kelvin	Control gear	Ref. N°	Ref. N° Trimless*
Note		facetted				4th quarter 2013
36W	Medium	high gloss	3000 K	ON/OFF	24.2M31DA.00	24T.2M31DA.00
36W	Medium	high gloss	3000 K	regulated DALI	24.2M31DC.00	24T.2M31DC.00
36W	Medium	high gloss	4000 K	ON/OFF	24.2M31JA.00	24T.2M31JA.00
36W	Medium	high gloss	4000 K	regulated DALI	24.2M31JC.00	24T.2M31JC.00
37W	Medium	high gloss	PAL+	DMX	24.2M257E.00 4th quarter 2013	24T.2M257E.00
36W	Flood	high gloss	3000 K	ON/OFF	24.2F31DA.00	24T.2F31DA.00
36W	Flood	high gloss	3000 K	regulated DALI	24.2F31DC.00	24T.2F31DC.00
36W	Flood	high gloss	4000 K	ON/OFF	24.2F31JA.00	24T.2F31JA.00
36W	Flood	high gloss	4000 K	regulated DALI	24.2F31JC.00	24T.2F31JC.00
37W	Flood	high gloss	PAL+	DMX	24.2F257E.00 4th quarter 2013	24T.2F257E.00
36W	Flood	white	3000 K	ON/OFF	24W2F31DA.00	24TW2F31DA.00
36W	Flood	white	3000 K	regulated DALI	24W2F31DC.00	24TW2F31DC.00
36W	Flood	white	4000 K	ON/OFF	24W2F31JA.00	24TW2F31JA.00
36W	Flood	white	4000 K	regulated DALI	24W2F31JC.00	24TW2F31JC.00
37W	Flood	white	PAL+	DMX	24W2F257E.00 4th quarter 2013	24TW2F257E.00

For emergency version

Ordering example: 24.2M31DA.00 → **N**24.2M31DA**U**00 1 hour battery 3W  
24.2M31DA.00 → **N**24.2M31DA**W**00 3 hour battery 1W

other optional luminaire light fluxes upon request: 1300lm (15W)/1800lm (21W)/2400lm (28W)

Accessories for LED 210.

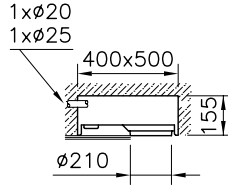
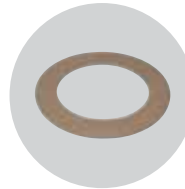

Decorative cover ring	Decorative cover ring with clear glass	Decorative cover ring with matt glass	Decorative cover ring with wallwasher	ring for ceiling reinforcement	concrete recessed box
Ø 240 mm, (outside)	IP55 from below Ø 240 mm, (outside)	IP55 from below Ø 240 mm, (outside)	90° adjust. after instal. Ø 240 mm, (outside)	ring thickness = 8 mm ceiling thickness < 3 mm	
24RIW210.01 white 24RIH210.01 silver	24RIW210K.01 white 24RIH210K.01 silver		24SETM210.01W white 24SETM210.01H silver	24SET210.01	24EB210.01
24RIW210.01 white 24RIH210.01 silver	24RIW210K.01 white 24RIH210K.01 silver		24SETM210.01W white 24SETM210.01H silver	24SET210.01	24EB210.01
24RIW210.01 white 24RIH210.01 silver	24RIW210K.01 white 24RIH210K.01 silver		24SETM210.01W white 24SETM210.01H silver	24SET210.01	24EB210.01
24RIW210.01 white 24RIH210.01 silver	24RIW210K.01 white 24RIH210K.01 silver		24SETM210.01W white 24SETM210.01H silver	24SET210.01	24EB210.01
24RIW210.01 white 24RIH210.01 silver	24RIW210K.01 white 24RIH210K.01 silver		24SETM210.01W white 24SETM210.01H silver	24SET210.01	upon request
24RIW210.01 white 24RIH210.01 silver	24RIW210K.01 white 24RIH210K.01 silver		24SETF210.01W white 24SETF210.01H silver	24SET210.01	24EB210.01
24RIW210.01 white 24RIH210.01 silver	24RIW210K.01 white 24RIH210K.01 silver		24SETF210.01W white 24SETF210.01H silver	24SET210.01	24EB210.01
24RIW210.01 white 24RIH210.01 silver	24RIW210K.01 white 24RIH210K.01 silver		24SETF210.01W white 24SETF210.01H silver	24SET210.01	24EB210.01
24RIW210.01 white 24RIH210.01 silver	24RIW210K.01 white 24RIH210K.01 silver		24SETF210.01W white 24SETF210.01H silver	24SET210.01	24EB210.01
24RIW210.01 white 24RIH210.01 silver	24RIW210K.01 white 24RIH210K.01 silver		24SETF210.01W white 24SETF210.01H silver	24SET210.01	upon request
24RIW210.01 white 24RIH210.01 silver	24RIW210K.01 white 24RIH210K.01 silver	24RIW210D.01 white 24RIH210D.01 silver		24SET210.01	24EB210.01
24RIW210.01 white 24RIH210.01 silver	24RIW210K.01 white 24RIH210K.01 silver	24RIW210D.01 white 24RIH210D.01 silver		24SET210.01	24EB210.01
24RIW210.01 white 24RIH210.01 silver	24RIW210K.01 white 24RIH210K.01 silver	24RIW210D.01 white 24RIH210D.01 silver		24SET210.01	24EB210.01
24RIW210.01 white 24RIH210.01 silver	24RIW210K.01 white 24RIH210K.01 silver	24RIW210D.01 white 24RIH210D.01 silver		24SET210.01	24EB210.01
24RIW210.01 white 24RIH210.01 silver	24RIW210K.01 white 24RIH210K.01 silver	24RIW210D.01 white 24RIH210D.01 silver		24SET210.01	upon request

\*Rimless for plastering; for product photo see page 16, not compatible with accessories

\*IP44 from below for closed ceilings

Echo LED 260.

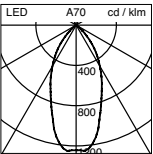

Spot,  
high gloss  
UGR <19

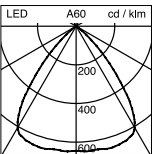

Flood, high gloss

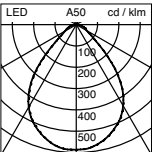

Flood, white

4200lm replaces HIT 70W,  
or CFL 2x42W

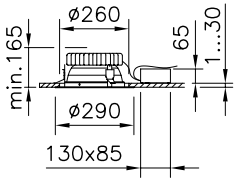

LED

IP20  
IP44\*

	Beam angle	Reflector surface	Kelvin	Control gear	Ref. N°
Note		facetted			
50 W	Spot	high gloss	3000K	ON/OFF	24.3S45DA.00
50 W	Spot	high gloss	3000K	regulated DALI	24.3S45DC.00
50 W	Spot	high gloss	4000K	ON/OFF	24.3S45JA.00
50 W	Spot	high gloss	4000K	regulated DALI	24.3S45JC.00
50 W	Flood	high gloss	3000K	ON/OFF	24.3F45DA.00
50 W	Flood	high gloss	3000K	regulated DALI	24.3F45DC.00
50 W	Flood	high gloss	4000K	ON/OFF	24.3F45JA.00
50 W	Flood	high gloss	4000K	regulated DALI	24.3F45JC.00
50 W	Flood	white	3000K	ON/OFF	24W3F45DA.00
50 W	Flood	white	3000K	regulated DALI	24W3F45DC.00
50 W	Flood	white	4000K	ON/OFF	24W3F45JA.00
50 W	Flood	white	4000K	regulated DALI	24W3F45JC.00

For emergency version

Ordering example: 24.3S45DA.00 → **N**24.3S45DA**U**00    1 hour battery 3W  
24.3S45DA.00 → **N**24.3S45DA**W**00    3 hour battery 1W

other optional luminaire light fluxes upon request: 1600lm (19W)/2300lm (27W)/3200lm (39W)

Accessories for LED 260.

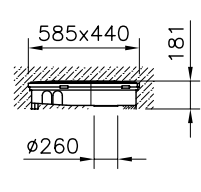

Decorative cover ring	Decorative cover ring with clear glass	Decorative cover ring with matt glass	Decorative cover ring with wallwasher	ring for ceiling reinforcement	concrete recessed box
Ø 298 mm, (outside)	IP55 from below Ø 298 mm, (outside)	IP55 from below Ø 298 mm, (outside)	90° adjust. after instal. Ø 298 mm, (outside)	ring thickness = 8 mm ceiling thickness < 3 mm	static clarification needed
24RIW260.01 white 24RIH260.01 silver	24RIW260K.01 white 24RIH260K.01 silver		24SETF260.01W white 24SETF260.01H silver	24SET260.01	24EB260.01
24RIW260.01 white 24RIH260.01 silver	24RIW260K.01 white 24RIH260K.01 silver		24SETF260.01W white 24SETF260.01H silver	24SET260.01	24EB260.01
24RIW260.01 white 24RIH260.01 silver	24RIW260K.01 white 24RIH260K.01 silver		24SETF260.01W white 24SETF260.01H silver	24SET260.01	24EB260.01
24RIW260.01 white 24RIH260.01 silver	24RIW260K.01 white 24RIH260K.01 silver		24SETF260.01W white 24SETF260.01H silver	24SET260.01	24EB260.01
24RIW260.01 white 24RIH260.01 silver	24RIW260K.01 white 24RIH260K.01 silver		24SETF260.01W white 24SETF260.01H silver	24SET260.01	24EB260.01
24RIW260.01 white 24RIH260.01 silver	24RIW260K.01 white 24RIH260K.01 silver		24SETF260.01W white 24SETF260.01H silver	24SET260.01	24EB260.01
24RIW260.01 white 24RIH260.01 silver	24RIW260K.01 white 24RIH260K.01 silver		24SETF260.01W white 24SETF260.01H silver	24SET260.01	24EB260.01
24RIW260.01 white 24RIH260.01 silver	24RIW260K.01 white 24RIH260K.01 silver	24RIW260D.01 white 24RIH260D.01 silver		24SET260.01	24EB260.01
24RIW260.01 white 24RIH260.01 silver	24RIW260K.01 white 24RIH260K.01 silver	24RIW260D.01 white 24RIH260D.01 silver		24SET260.01	24EB260.01
24RIW260.01 white 24RIH260.01 silver	24RIW260K.01 white 24RIH260K.01 silver	24RIW260D.01 white 24RIH260D.01 silver		24SET260.01	24EB260.01
24RIW260.01 white 24RIH260.01 silver	24RIW260K.01 white 24RIH260K.01 silver	24RIW260D.01 white 24RIH260D.01 silver		24SET260.01	24EB260.01

\*IP44 from below for closed ceilings





BITTE MIT  
HÄNDLICH TRAHEN

DU  
MUSST  
JETZT  
STARK  
SEIN.

# Glossary.

Psys:	System power in Watts (W)
LL:	Luminous flux in lumens (lm)
CCT:	Correlated color temperature in Kelvin (K)
CRI:	Colour Rendering Index
L70:	LED lifespan. Currently typically 50,000hrs, number of operating hours after which the light diode still retains a minimum of 70% of its original luminous flux
UGR:	Unified Glare Rating, evaluation of the glare standard CIE S 008/E, ISO 8995 (CIE117)
PAL+	<b>1 luminaire</b> (PAL+ complete colour recognition, true-white LEDs without UV/IR), <b>3 settings</b> (“PAL”, “FOOD”, “COLOUR”), <b>17 colour tones</b> (“PAL”: true-white, 2500K, 2700K, 3000K, 3500K, 4000K, 4500K, 5000K, 5700K, 6500K; “FOOD”: meat red, cheese yellow, fish red, bakery goods; “COLOUR”: light green, blue, red, magenta)



# Offices

**Hauptsitz Schweiz** Regent Beleuchtungskörper AG, Dornacherstrasse 390, Postfach 246, CH-4018 Basel, Tel. +41 61 335 51 11, Fax +41 61 335 52 01, info.bs@regent.ch **Bern** Regent Beleuchtungskörper AG, Jupiterstrasse 15, Postfach 170, CH-3000 Bern 15, Tel. +41 31 940 10 10, Fax +41 31 940 10 11, info.be@regent.ch **Genève** Régent Appareils d'éclairage SA, Rue de Saint-Jean 30, CH-1203 Genève, Tél. +41 22 340 34 00, Fax +41 22 340 38 82, info.ge@regent.ch **Lausanne** Régent Appareils d'éclairage SA, Chemin du Rionzi 60, Case postale 432, CH-1052 Le Mont-sur-Lausanne, Tél. +41 21 642 02 02, Fax +41 21 648 21 19, info.ls@regent.ch **Lugano** Regent Illuminazione SA, Via al Mulino 22, CH-6814 Cadempino, Tel. +41 91 966 77 33, Fax +41 91 967 11 01, info.ti@regent.ch **Zürich** Regent Beleuchtungskörper AG, Luggwegstrasse 9, CH-8048 Zürich, Tel. +41 44 497 31 11, Fax +41 44 497 31 61, info.zh@regent.ch **Head Office International** Regent Beleuchtungskörper AG, Dornacherstrasse 390, P.O. Box 246, CH-4018 Basel Switzerland, Tel. +41 61 335 54 82, Fax +41 61 335 55 96, export.bs@regent.ch **Deutschland** Regent Licht GmbH, TechnologiePark, Friedrich-Ebert-Strasse, D-51429 Bergisch Gladbach, Tel. +49 2204 84 37 80, Fax +49 2204 84 37 81, info@regent-licht.de **France** Régent Appareils d'éclairage Sàrl, Siège social 10, place Charles Béraudier, Immeuble l'Orient, F-69428 Lyon Cedex 03, Régent Appareils d'éclairage SA, Siège commercial, Dornacherstrasse 390, Case postale 246, CH-4018 Bâle Suisse, Tél. +41 61 335 54 83, Fax +41 61 335 55 96, info.fr@regent.ch **Israel** Regent Lighting Marketing Ltd., 4, Moshe Sharet St., IL-75704 Rishon Letzion, Phone +972 3 962 29 70, Fax +972 3 962 29 98, service@regentlighting.co.il **Italia** Regent Illuminazione s.r.l., Sede legale, Via Vittor Pisani 16, I-20124 Milano, Tel. +39 02 667 183 78, Fax +39 02 673 861 09, info.it@regent.ch **Österreich** Regent Licht GmbH, Karl-Farkas-Gasse 22, A-1030 Wien, Tel. +43 1 879 12 10, Fax +43 1 879 12 09, info@regent-licht.at **United Kingdom** Regent Lighting UK Ltd., Phone +44 7515 28 65 37, info@regent-lighting.co.uk **India** Regent Lighting Asia Private Limited, A-40, Ground Floor, Sector-80, Phase-II, Noida-201 305, Uttar Pradesh, India, Phone +91 120 473 3028 (North India) Phone +91 120 473 3031 (South & West India) info@regent-lighting.in

[www.regent.ch](http://www.regent.ch)



80.067.EN